

## G M500 SERIES

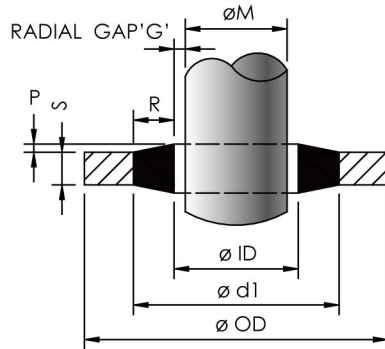

THREAD DIA 'M'		SIZE REF		OD +0.13	ID	d1	R		P		RADIAL GAP 'G'+0.07		MINIMUM BURST PRESSURE BAR
INCH	B.S.P	***	+	-0.00	±0.13	±0.13	S	±0.13		INCH	B.S.P		
6BA		001	1	6.35	3.05	4.09	1.2	±0.10	0.54	0.2/0.38		0.13	2150
4BA		002	2	7.26	4.12	5.26		0.57	0.26		1570		
2BA		003	3	8.38	5.21	6.35		0.57	0.26		1360		
1/4		004	4	13.21	6.86	8		1.27	0.32		2430		
1/4		005	5	13.34	6.99	9.53		0.56	0.19		1680		
5/16		006	6	13.34	8.31	9.53		0.70	0.35		1750		
5/16		007	7	14.22	8.64	10.04		0.73	0.42		1480		
3/8	1/8	020	A	15.88	10.37	11.84	0.60	0.55	1950				
.40		008	8	18.36	11.26	12.45	0.70	0.29	1890				
7/16		009	9	19.05	11.69	13.08	0.73	0.52	0.29	1540			
1/2	1/4	021	B	20.57	13.74	15.21	2.0	±0.10	0.76	0.29	1560		
9/16		010	10	22.23	14.86	16.39	0.73	0.30	1290				
.60		022	BB	22.23	15.83	17.30	1.12	0.32	1560				
5/8		011	11	25.40	16.51	18.75	0.73	0.31	1230				
	3/8	023	C	23.80	17.28	18.75	0.76	0.35	1310				
11/16		012	12	25.40	18.16	19.69	0.76	0.32	1230				
3/4		024	CC	26.92	19.69	21.21	0.73	0.45	0.29	1120			
13/16	1/2	025	D	28.58	21.54	23.01	0.74	0.63	0.29	1240			
7/8	5/8	026	E	31.75	23.49	24.97	0.89	0.23	1275				
15/16		013	13	33.27	24.26	26.04	0.74	0.82	0.30	1050			
1	3/4	027	F	34.93	27.05	28.53	1.40	0.41	1210				
1-1/16		028	FF	38.61	27.82	30.61	0.76	0.38	880				
1-1/8		014	14	36.58	29.33	30.86	0.74	0.33	0.30	860			
1-3/16	7/8	029	G	38.10	30.81	32.29	1.52	0.45	775				
1-1/4		015	15	41.40	32.64	35.69	3.2	1.50	0.28	0.40	780		
1-5/16	1	030	H	42.80	33.89	36.88	3.2	1.50	0.28	0.40	780		
1-5/16	1	031	HH	42.80	33.89	36.88	2.3	±0.10	1.50	0.28	0.40	780	
1-3/8		016	16	44.45	35.94	38.99	1.52	0.51	680				
1-1/2		017	17	47.75	38.96	42.04	1.54	0.43	660				
1-5/8	1-1/4	032	J	52.38	42.93	45.93	1.50	0.82	0.51	690			
1-3/4		018	18	57.15	45.34	48.39	1.52	0.45	870				
1-7/8	1-1/2	033	K	58.60	48.44	51.39	1.47	0.40	0.32	690			
2		019	19	63.50	51.69	54.74	1.52	0.45	780				
2-1/8	1-3/4	034	L	69.85	54.89	58.30	3.2	1.70	0.45	0.57	950		
2-1/4		035	LL	70.36	58.04	61.09	1.52	0.45	740				
	2	036	M	73.03	60.58	63.63	1.52	0.48	720				
2-1/2		037	MM	77.72	64.39	67.44	1.52	0.45	750				
	2-1/4	038	N	79.50	66.68	69.98	1.65	0.59	670				
	2-1/2	039	P	90.17	76.08	79.38	1.65	0.45	680				

## G M500 SERIES

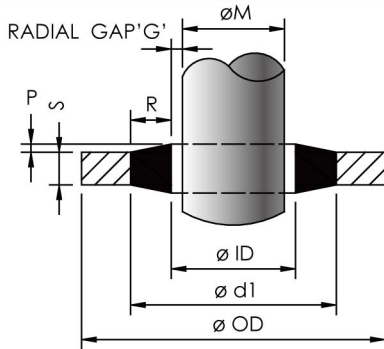

THREAD DIA 'M'	SIZE REF ***	OD +0.13 -0.00	ID ±0.13	d1 ±0.10	S	R ±0.1	P +0.25 0.00	RADIAL GAP 'G' ±0.05	MINIMUM BURST PRESSURE BAR	
3.5	201	7.2	4.1	5.2	1	0.55	0.3	0.30	1600	
4	202	7	4.5	5.4		0.45		0.25	1270	
5	203	9	5.7	6.8		0.65		0.35	1400	
5	204	10	5.7	7.4		0.85		0.35	1510	
5.5	205	9.2	6.2	7.2		0.5		0.35	1220	
6	206	10	6.7	8		0.65		0.35	1120	
6	207	11	6.7	8.2		0.75		0.35	1480	
6	208	11	6.7	8.2		2.5		0.75	0.35	1480
6.5	209	12	7.1	8.8	±0.1	0.85	0.4	0.30	1560	
8	211	13.4	8.5	9.4		1		0.45	0.25	1780
8	212	13	8.7	10		1		0.65	0.35	1330
8	213	14	8.7	10.4		1		0.85	0.35	1510
10	216	16	10.35	12		2		0.82	0.17	1470
10	217	16	10.7	12.4		1.5		0.85	0.35	1300
10	218	18	10.7	12.4				0.85	0.35	1880
11	220	18.5	11.8	13.7				0.95	0.4	1540
12	222	18	12.7	14.4				0.85	0.35	1150
12	223	20	12.7	14.4				0.85	0.35	1680
14	227	22	14.7	16.4	0.85		0.35	1510		
16	229	24	16.7	18.4	0.85		0.35	1370		
17	230	24	17.4	19.2	0.9		0.2	1150		
18	232	26	18.7	20.4	0.85	0.35	1260			
20	233	28	20.7	22.5	2	0.9	0.35	1140		
22	236	30	22.7	24.4		0.85	0.35	1080		
22	237	30	22.7	24.4	3	±0.1	0.85	0.35	1080	
24	238	32	24.7	26.4	±0.1	0.85	0.35	1000		
26	239	35	26.7	28.4		0.85	0.35	1090		
27	240	36	27.2	29		0.9	0.1	1130		
28	241	37	28.7	30.4		2	0.85	0.35	1030	
30	242	39	31	33		1	0.5	870		
33	243	42	33.7	35.8		1.05	0.35	840		
36	245	46	36.7	38.8		1.05	0.35	890		
42	247	53	42.7	44.4		3	0.85	0.35	930	
48	248	59	48.7	50.8	±0.15		1.05	0.35	790	

## G M500 SERIES

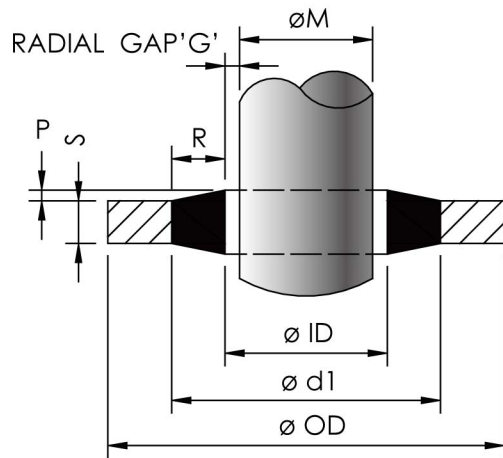

THREAD DIA "M"	SIZE REF ***	OD +0.13 -0.00	ID ±0.13	d1 ±0.10	S	R ±0.1	P +0.25 0.00	RADIAL GAP 'G' ±0.05	MINIMUM BURST PRESSURE BAR
6.7	210	10.2	7.3	8.6	1	0.65	0.3	0.3	850
8	214	16	8.7	10.4		0.85		0.35	2150
8.5	215	13.3	9.3	10.5	1.5	0.6	0.4	0.4	1200
11	219	16.3	11.4	12.7		0.65		0.2	1280
11	221	19.1	11.8	13.5		0.85		0.4	1760
13	224	20	13.7	15.4		±0.1		0.35	1340
13	225	22	13.7	15.4		0.85		0.35	1810
13	315	20.1	13.8	15.2		0.7		0.4	1430
13.5	226	18.7	14	15.7		0.85		0.25	900
15	228	22.7	16	17.78		0.89		0.5	1260
17.5	231	24.7	18	20.1		1.05		0.25	1070
21	234	28.7	21.5	23.3		2.5 ±0.15		0.9	0.25
22	235	28	22.5	24.2	1.5	0.4	0.25	760	
23	325	32	23.7	25.4	0.85		0.35	965	
26	327	35.3	27	28.7	0.85		0.5	860	
28	329	36	28.6	30.3	2 ±0.1		0.3	720	
28.5	330	37.5	29.2	30.9	0.85		0.35	810	
33	244	43	34.3	36.4	1.05		0.65	870	
39	246	51	40	41.9	2.5		0.95	0.5	1030
51	249	60	52	54.1	3			0.5	540
52	250	64.5	53.3	56.4			0.65	0.710	
60	251	73	60.7	63	1.15		0.35	780	
68	252	79.5	68.6	72.1	3.5 ±0.15	1.75	0.3	510	
75	253	90.3	76.08	79.1	3.38	1.51	0.54	700	
88	254	101.48	89.09	92.1	3.2	1.5	0.54	510	
125	255	143.67	127	132.7	5		1	420	
6	305	13.27	6.85	8	1.3 ±0.1	0.57	0.3	0.42	1970
16.5	319	23.9	17.2	18.7	2	0.75	0.4	0.35	1020

## G M500 SERIES

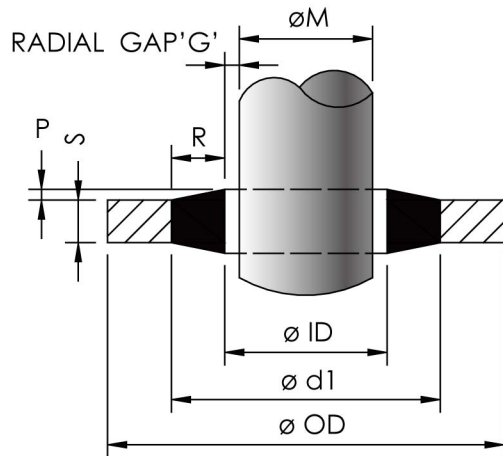

THREAD DIA "M"	SIZE REF ***	OD +0.13 -0.00	ID ±0.13	d1 ±0.10	S	R ±0.1	P +0.25 0.00	RADIAL GAP 'G' ±0.05	MINIMUM BURST PRESSURE
3	301	7.5	3.6	5	1	0.7	0.30	0.3	1980
4	302	9	4.6	6	1	0.7			2000
5	303	10	5.6	7	1	0.7			1780
6	304	11	6.6	8	1	0.7			1680
6	306	11.4	7	8.4	1	0.7	0.4	0.5	1540
8	307	13	8.6	10	1	0.7		0.3	1330
10	310	17	10.7	12.1	1.5	0.7		0.35	1730
11	312	18.1	11.8	13.2	1.5	0.65		0.4	1610
12	313	19	12.7	14.1	1.5	0.7	±0.1	0.4	1530
14	316	21	14.7	16.1	1.5	0.7			1370
16	317	23	16.7	18.1	1.5	0.7			1240
18	320	27	18.7	20.4	2	0.85			1450
20	321	29	20.7	22.4	2	0.85			1340
22	324	31	22.7	24.4	2	0.85			1240
24	326	33	24.7	26.4	2	0.85			1160
27	328	36	27.7	29.4	2	0.85			1060
30	331	39	30.7	32.4	2	0.85			970
33	332	42	33.7	35.4	2	0.85			0.35
36	333	48	37	39.6	2.5	1.3	±0.15	0.5	1010
39	334	51	40	42.6	2.5	1.3			950
42	335	54	43	45.6	2.5	1.3			890
45	336	57	46	48.6	2.5	1.3			860
48	337	60	49	51.6	2.5	1.3			790

## G M500 SERIES

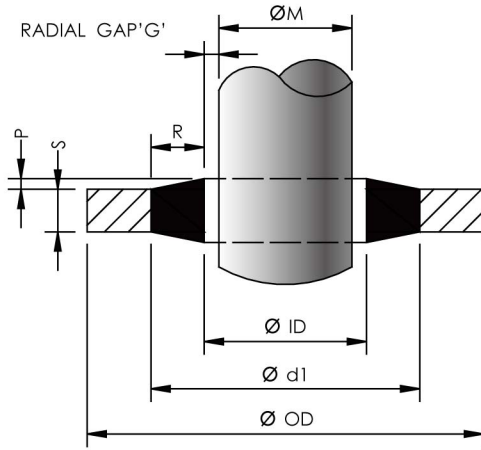

THREAD DIA 'M'	SIZE REF ***	OD +0.0 -0.2	ID +0.2 -0.0	d1 +0.2 -0.0	S	R ±0.2	P +0.25 -0.00	MINIMUM BURST PRESSURE BAR
1/16	519	12.7	8.3	9.9	1.20	1.4	0.25	1100
1/8	510	14.7	10.4	12		1.35		930
1/4	511	18.7	13.85	15.75		1.47		793
3/8	512	22.7	17.35	19.25		1.72		775
1/2	513	26.7	21.65	23.55		1.57		586
3/4	514	32.5	27.3	29.2		1.65		500
1	515	39.5	34.2	36.1	2	1.7	414	
1-1/4	516	49.5	42.8	44.7		2.4	500	
1-2/2	517	55.5	48.7	50.6		2.45	434	
2	518	68.5	60.5	62.4		3.05	448	
	520	32.6	27.3	29.2				

## G M500 SELF-CENTERING SERIES

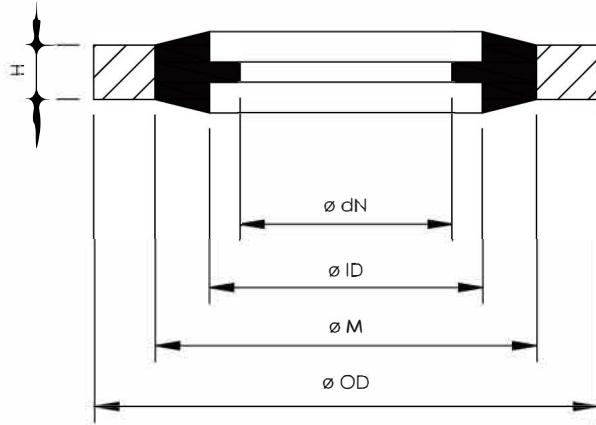

METRIC THREAD	ØOD		ØM	ØID		ØdN		H	SIZE REF.
M4	7.00		5.40	4.50		3.40		1.00	947
M5	10.00		7.40	5.70		4.45		1.00	946
M6	10.00		8.00	6.70		5.60		1.00	898
M8	14.00		10.40	8.70		6.40		1.00	866
BSP 1/8	15.88		11.84	10.37		8.26		2.00	820
M10	16.00		12.40	10.70		8.05		1.50	708
M12	19.00		14.10	12.70		9.73		1.50	867
BSP 1/4	20.57		15.21	13.74		11.18		2.00	821
M14	22.00		16.40	14.70		11.38		1.50	868
5/8	25.40		18.75	16.51		12.90	+ 0.25	2.00	869
M16	24.00		18.40	16.70		13.41	- 0	1.50	870
BSP 3/8	23.80		18.75	17.28		14.96		2.00	823
11/16	25.40		19.69	18.16		14.50		2.50	871
M18	26.00	+ 0.13	20.40	18.70	±0.13	14.76		1.50	872
M20	28.00	- 0	22.50	20.70		16.76		1.50	873
BSP 1/2	28.58		23.01	21.54		18.64		2.50	825
M22	30.00		24.40	22.70		18.74		2.00	874
BSP 5/8	31.75		24.97	23.49		20.27		2.30	826
M24	32.00		26.40	24.70		20.11		2.00	875
BSP 3/4	34.93		28.53	27.05		24.13		2.47	827
BSP 7/8	38.10		32.29	30.81		27.51		2.47	829
BSP 1	42.80		36.88	33.89		29.92		3.20	830
BSP 1 1/4	52.38		45.93	42.93		38.45		3.20	832
BSP 1 1/2	58.60		51.39	48.44		44.45	+ 0.37	3.20	833
BSP 1 3/4	69.85		58.30	54.89		50.42	- 0	3.20	834
BSP 2	73.03		63.63	60.58		56.26		3.20	836
BSP 2 1/4	79.50		69.98	66.68		62.36		3.20	838
BSP 2 1/2	90.17		79.38	76.08		71.50		3.20	839

## G M1000 SERIES

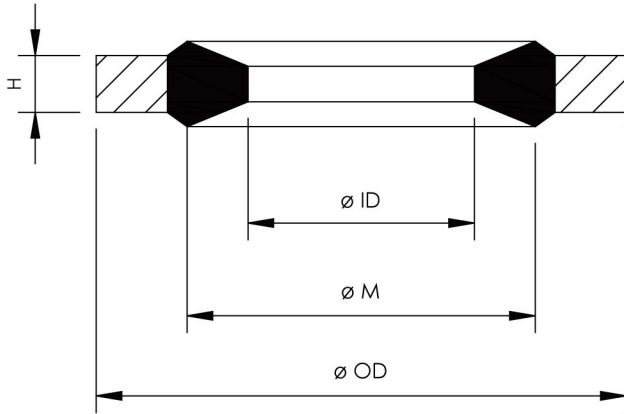

METRIC THREAD	KEY WIDEN	THROUGH HOLE		Dimensions					
SIZE M	mm	DIN 69f	DIN 69	ØOD	ØM	ØID	H		
M3	6			6	4.5	3		1	
M4	7	4.3	4.5	8	6	4		1	
M5	8	5.3	5.5	9	6.4	5		1	
M6	10	6.4	6.6	10	7.4	6		1	
M7	11	7.4	7.6	11	8.5	7		1	
M7.5		8.4	9	13	10	8		1	
M8	14	8.4	9	14	10	8		1	
M10	17	10.5	11	17	12 +1	10		1.5	
M11	18	10.5	11	18	12	10		1.5	
M12	19	13	14	19	15 +1	12		1.5	
M14	22	15	16	22	17 +1	14		1.5	
M16	24	17	18	24	19 +1	16		1.5	
M18	27	19	20	27	21 +1	18	± 0.10	2	± 0.10
M20	30	21	22	30	24	20		2	
M22	32	23	24	32	26 +1	22		2	
M23	35			35	30	26		2	
M24	36	25	26	36	28	24		2	
M27	41	28	30	41	32	27		2	
M30	46	31	33	46	34	30		2	
M33	50	34	36	50	38	33		2.5	
M36	55	37	39	55	42	36		2.5	
M39	60	40	42	60	46	39		2.5	
M42	65	43	45	65	50	42		2.5	
M45	70		48	70	54	45		3	
M48	75	50	52	75	60	48		3	
M52	80	54	56	80	64	52		3	

## G M2000 SERIES

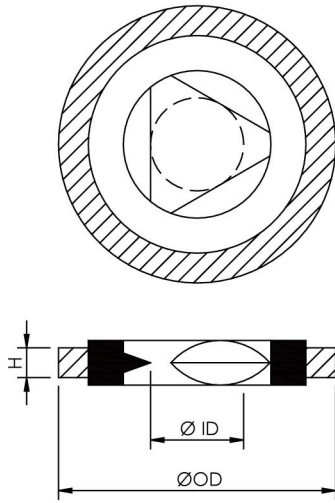

METRIC THREAD	kem O	ØOD	ØID	H
MA4	3.09	8	3.1	1.0
MA5	3.96	9	4	1.0
MA6	4.7	10	4.7	1.0
MA8	6.37	14	6.4	1.5
MA10	8.05	17	8.1	1.5
MA12	9.72	19	9.8	1.5
MA14	11.4	22	11.5	2.0
MA16	13.4	24	13.5	2.5
MA18	14.75	27	14.8	2.5
MA20	16.75	30	16.8	2.5
MA22	18.75	32	18.8	2.5
MA24	20.1	36	20.2	3.0
MA27	23.1	41	23.2	3.0
MA30	25.45	46	25.5	3.0
MA33	28.45	50	28.5	3.0
MA36	30.8	55	31	3.0
MA39	33.8	60	34	4.0
MA42	36.15	65	36.3	4.0
MA45	39.15	70	39.3	4.0
MA48	41.5	75	41.7	4.0
MA52	45.5	80	45.7	4.0

## U-SEAL SERIES

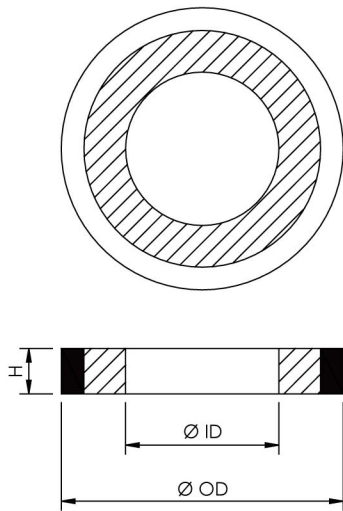

METRIC THREAD	ØOD		ØID		H	
UA4	7.2	± 0.10	4.1	+ 0.10 - 0	1.0	± 0.10
UA5	8.7		5.2		1.0	
UA6	9		6.2		1.0	
UA6	10		6.2		1.0	
UA8	12		8.2		1.0	
UA8	13		8.2		1.0	
UA8	14		8.2		1.0	
UA10	16		10.2		1.5	
UA10	16		10.0		1.5	
UA12	18		12.2		1.5	
UA12	18		12.0		1.5	
UA13	21.5		13.3		1.5	
UA16	22		16.2		1.5	
UA16	22		16.0		1.5	
UA14	24		14.0		2.0	
UA20	28		20.0		2.5	

## LOCKSEALS SERIES

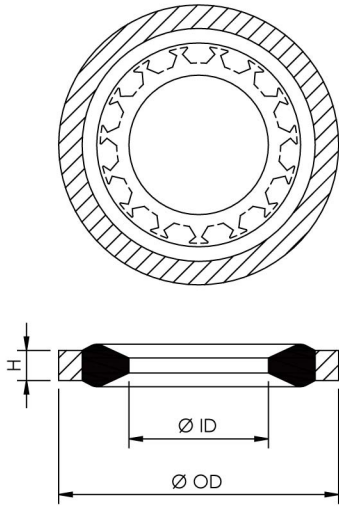

Dimensions						PART
ØOD		ØID		H		NO.
15.30	± 0.13	6.0	± 0.10	1.20	± 0.10	
15.30		7.6		1.30		
16.00		8.2		1.30		44-150
16.80		9.3		1.30		
18.50		10.0		1.00		
19.10		11.2		1.30		44-151
33.40		15.2		3.10		
28.00		15.3		1.30		44-011
23.60		15.4		1.30		44-152
30.00		15.5		3.00		44-010
30.12		15.5		5.53		
30.40		15.7		3.66		
25.40		17.1		1.30		44-153
31.50		17.4		1.30		44-012